

**MEDIT Link** + **Carestream**  
DENTAL

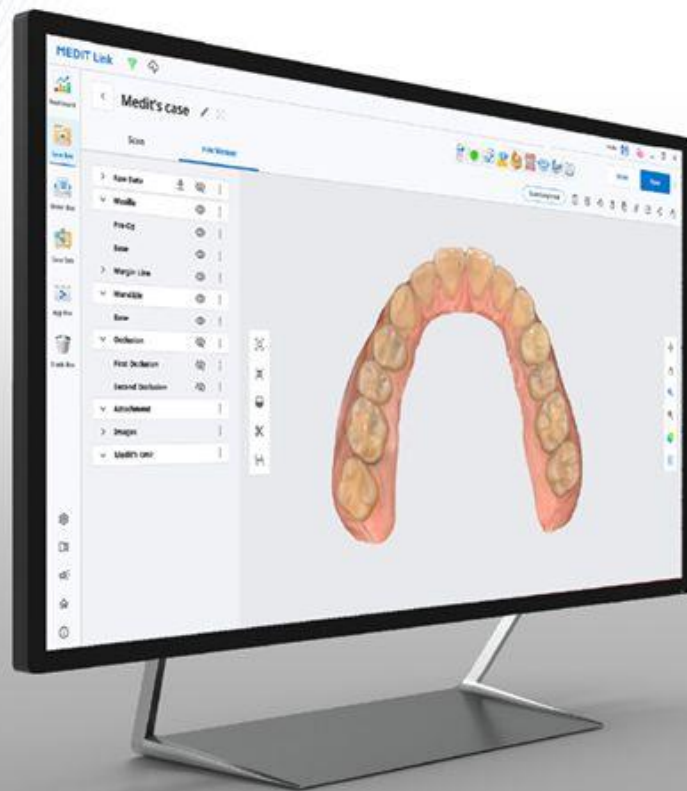

**MEDIT**



Medit

9,582 follower

2s • 🌐



We are excited to share with you that Carestream Dental's CS Imaging version 8 has been integrated with Medit Link!

Users can now open up Medit Link from CS Imaging, scan, and then view the scan data from CS Imaging directly.

Carestream Dental's CS Imaging version 8 centralizes and displays all 2D and 3D images, along with CAD/CAM data, in one convenient location to aid in more comprehensive diagnoses, optimized treatment workflows and enhanced case presentation.

Please reach out to a local Carestream Dental representatives for any inquiries.

If you wish to know more, please click the link below:

[https://hubs.la/Q01BWH\\_D0](https://hubs.la/Q01BWH_D0)

#Medit #Meditlink #Carestreamdental #CSImagingv8 #Integration #PACS  
#scandata #Imaging #digitaldentistry

MEDIT

- Dashboard
- Case Box
- Order Box
- Case Talk
- App Box
- Trash Box

# App Box

# Install the application

Cerca per Informazioni sull'App

Tutto Medit Apps Partner Apps

Tutte le app Tutte le categorie

**DWS DFAB Integration**

Stampa 3D Socio

Di DWS s.r.l. | v 1.0.0.0 | 2023-02-20

Download totali 48

[Installa](#)

**Phrozen DS Slicer Integration**

Socio Stampa 3D

Di Phrozen | v 1.0.1.0 | 2023-02-16

Download totali 262

[Installa](#)

**CS Imaging Integration**

Socio PACS/PMS Software di imaging

Di Carestream Dental | v 1.0.0.0 | 2023-02-10

Download totali 220

[Installa](#)

**TrioClear Integration**

Allineatore invisibile Piattaforma di ordinazione Socio

Di TrioClear | v 1.0.2.0 | 2023-02-02

Download totali 444

[Installa](#)

**Dentbird Crown Integration**

CAD Socio Piattaforma di ordinazione

Di Imagoworks Inc. | v 1.2.23.0 | 2023-01-03

Download totali 771

[Aggiorna](#)

**fastscan.io Integration**

Strumento

Di Medit R&D | v 1.0.1.0 | 2022-12-16

Download totali 998

[Installa](#)

**Andcom Integration**

Paziente PACS/PMS

Di ANDCOM | v 1.0.0.0 | 2022-12-06

**HeyGears Integration**

Piattaforma di ordinazione Socio Stampa 3D

Di HeyGears | v 1.0.2.0 | 2022-12-06

**LOGOSw Integration**

Paziente

Di IMAGEX | v 1.0.0.0 | 2022-11-24

**Medit i700 wireless**

Magic Made Easy with a Simple Touch

[Learn more >](#)

**Medit i600**

The Brain of the i700 with a Splash of Color

[Learn more >](#)

Check that the programme is correctly installed

The screenshot shows a user interface for an application marketplace. At the top, there are two filters: 'Tutte le app' (All apps) and 'Tutte le categorie' (All categories). Below this, the 'CS Imaging Integration' app is displayed. It features a logo, a category tag 'Socio', and sub-categories 'PACS/PMS' and 'Software di imaging'. The developer is 'Di Carestream Dental', the version is 'v 1.0.0.0', and the release date is '2023-02-10'. Below the app details, it shows 'Download totali 220' (Total downloads 220) and a grey button labeled 'Installato' (Installed). A red box highlights the 'Installato' button, and a green arrow points from the text on the left towards it. Below the first app, the 'fastscan.io Integration' app is partially visible, with a logo, category tag 'Strumento', developer 'Di Medit R&D', version 'v 1.0.1.0', and release date '2022-12-16'.

MEDIT Link 3.0.6

massimiliano urso

### ZUNINO FABIO's Case 5 (ZUNINO FABIO, 1)

Modulo Visualizzatore file

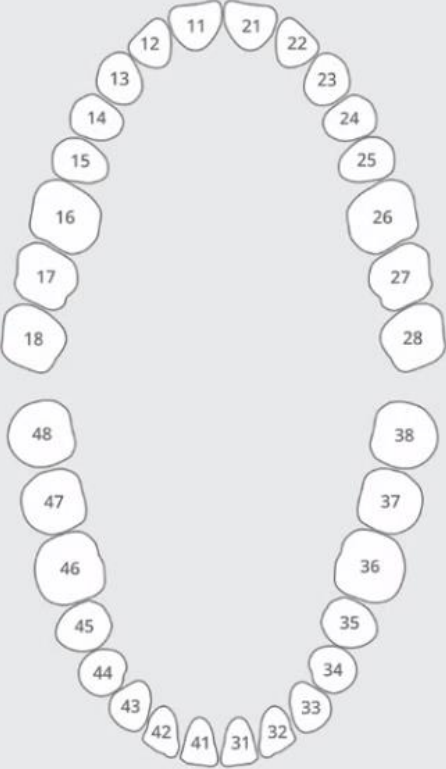

Form Only

Tipo	Metodo	Materiale	Tonalità	Preferiti	
Intarsio inlay		Intarsio onlay		Cappetta	Corona anatomica
Corona		Pontic		Perno moncone	Faccetta
Corona su impianto		Abutment personalizzato		Guida chirurgica	Sottostruttura
Abutment personalizzato + ...		Abutment personalizzato + C...		Ceratura diagnostica	Dentiera parziale

Elenco degli ordini

No.	Tipo	Metodo	Materiale	Tonalità
-----	------	--------	-----------	----------

Annulla Salva

contrary to the other apps, you will not see the Carestream icon at the top of the bar.

CS Imaging 8.0.22

ZUNINO FABIO

Nome ZUNINO FABIO  
Data di nascita 10/08/1972  
SSN

Ordina per Cognome

ZURLO MASSIMILIANO	04/08/1972
a7002df041f211ebbca9	
ZURLO MASSIMILIANO	04/08/1972
debbf8a4e20c42d08674	
ZUPPA LILIANA	27/10/1955
0970b8e1458511e9b94b1402ec98ab47	
<b>ZUNINO FABIO</b>	<b>10/08/1972</b>
473801c038f111edac3f	
ZUNINO FABIO	10/08/1972
1931dfc18b4f4a848d0a	
ZUIN ELSA	18/08/1952
15a3171eb9c011e99dc01402ec98ab47	
ZUCCA GIUSEPPINA	05/02/1975
3c1a56eeb9934135a0c9	
ZUCARO DANIELA FILOME...	30/10/1968
9c1348c40e0f4e7b9552	
ZIN ARIANNA	

1986

SCAN

Data | Tipo | Filtri

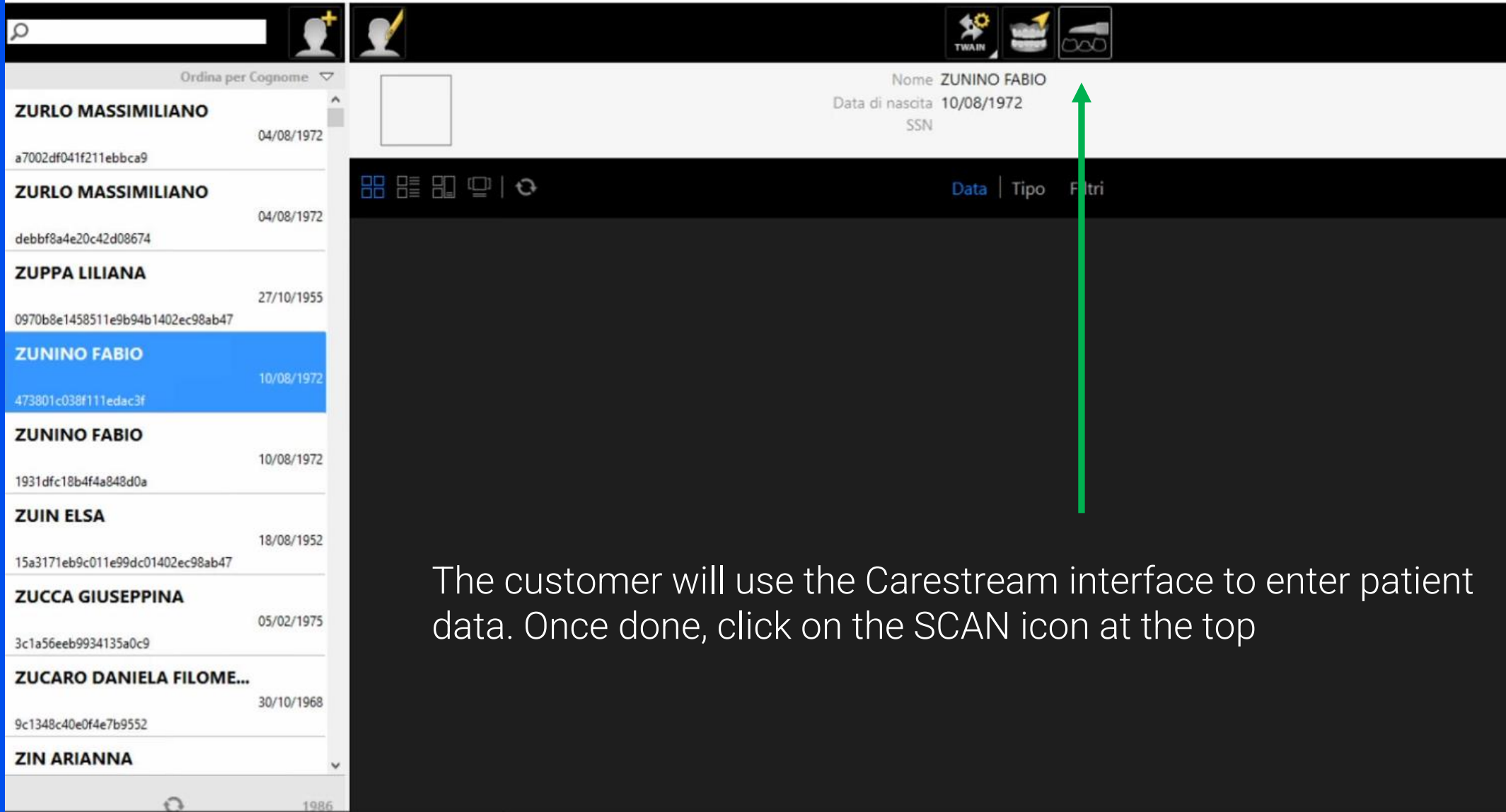

The customer will use the Carestream interface to enter patient data. Once done, click on the SCAN icon at the top

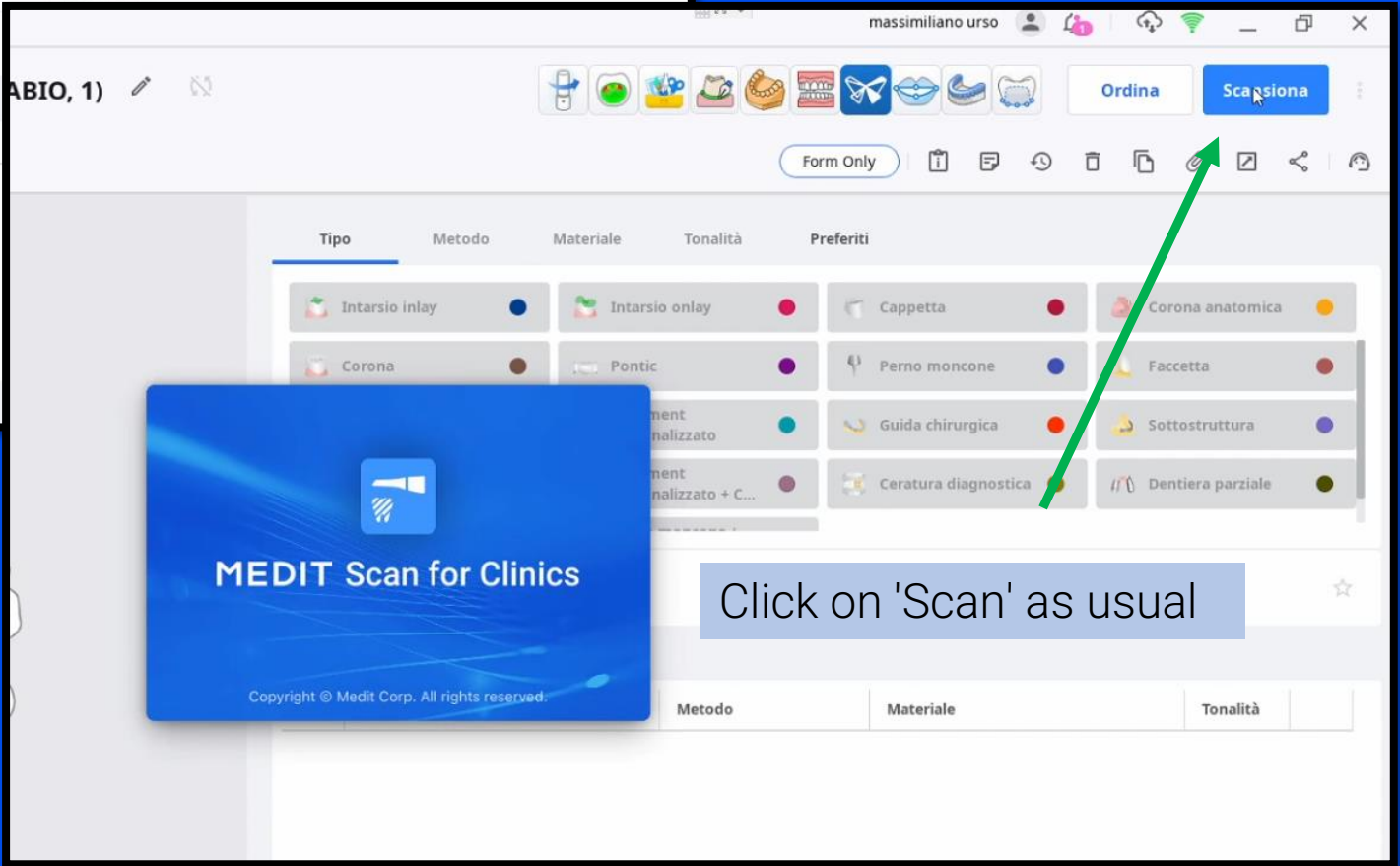
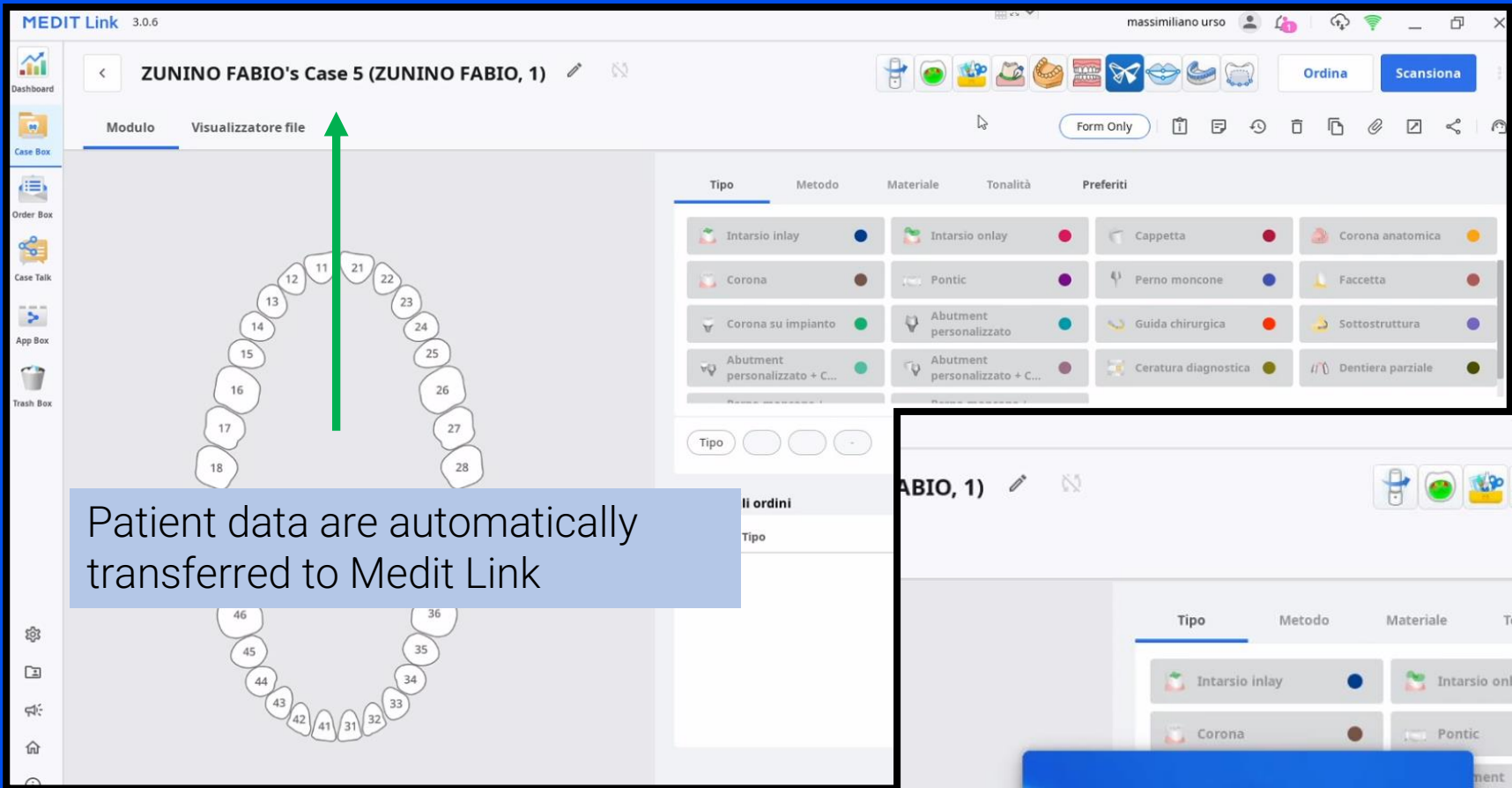

Ritaglio



Strumenti



Informazioni sul modulo

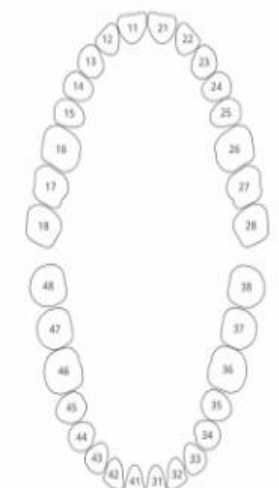

Proceed with the patient scan.

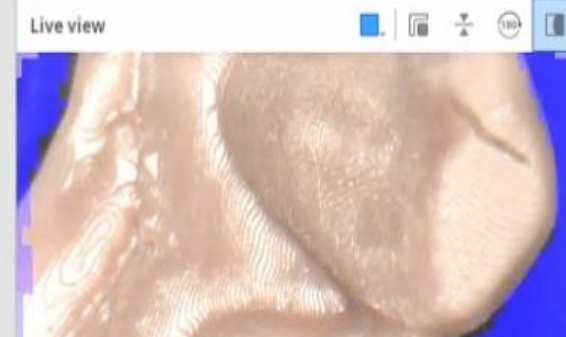























# ZUNINO FABIO's Case 5 (ZUNINO FABIO, 1)



Processing    

Tipo	Metodo	Materiale	Tonalità	Preferiti
 Intarsio inlay		 Intarsio onlay		 Cappetta
 Corona		 Pontic		 Perno moncone
 Corona su impianto		 Abutment personalizzato		 Guida chirurgica
 Abutment personalizzato + C...		 Abutment personalizzato + C...		 Ceratura diagnostica

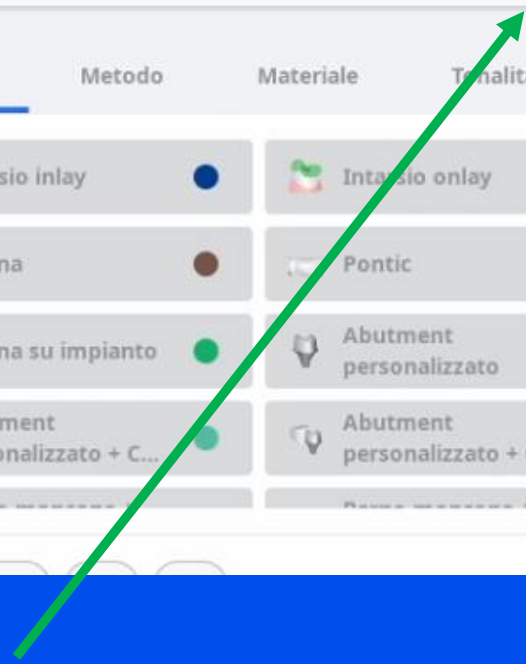
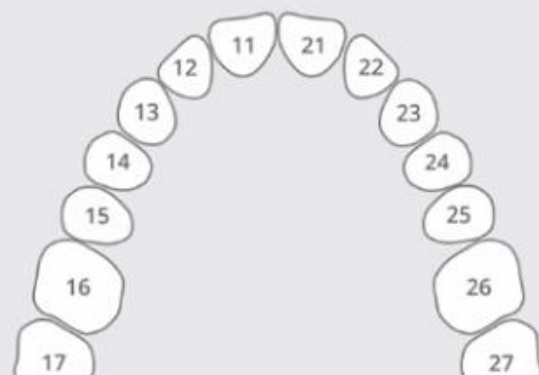

Wait until the end of the processing stage

Search bar with magnifying glass icon and a user profile icon with a plus sign.

Ordina per Cognome ▾

<b>ZURLO MASSIMILIANO</b>	04/08/1972
a7002df041f211ebbca9	
<b>ZURLO MASSIMILIANO</b>	04/08/1972
debbf8a4e20c42d08674	
<b>ZUPPA LILIANA</b>	27/10/1955
0970b8e1458511e9b94b1402ec98ab47	
<b>ZUNINO FABIO</b>	10/08/1972
473801c038f111edac3f	
<b>ZUNINO FABIO</b>	10/08/1972
1931dfc18b4f4a848d0a	
<b>ZUIN ELSA</b>	18/08/1952
15a3171eb9c011e99dc01402ec98ab47	
<b>ZUCCA GIUSEPPINA</b>	05/02/1975
3c1a56eeb9934135a0c9	
<b>ZUCARO DANIELA FILOME...</b>	



Nome **ZUNINO FABIO**  
Data di nascita 10/08/1972  
SSN

Data | Tipo | Filtri

Importa modello

Importing is in progress, please wait...

Visualizza dettagli Annulla



Once the process is finished, the file is automatically uploaded to the CS Imaging platform

Search bar with a magnifying glass icon and a user profile icon with a plus sign.

User profile icons: a user profile with a pencil and a TWAIN scanner icon.

Ordina per Cognome ▾

**ZURLO MASSIMILIANO**  
04/08/1972  
a7002df041f211ebbca9

**ZURLO MASSIMILIANO**  
04/08/1972  
debbf8a4e20c42d08674

**ZUPPA LILIANA**  
27/10/1955  
0970b8e1458511e9b94b1402ec98ab47

**ZUNINO FABIO**  
10/08/1972  
473801c038f111edac3f

**ZUNINO FABIO**  
10/08/1972  
1931dfc18b4f4a848d0a

**ZUIN ELSA**  
18/08/1952  
15a3171eb9c011e99dc01402ec98ab47

**ZUCCA GIUSEPPINA**  
05/02/1975  
3c1a56eeh003d135a0r0



Nome ZUNINO  
Data di nascita 10/08/1972  
SSN



Data



28/02/2023 13:44

Once uploaded, the file will be available for use.

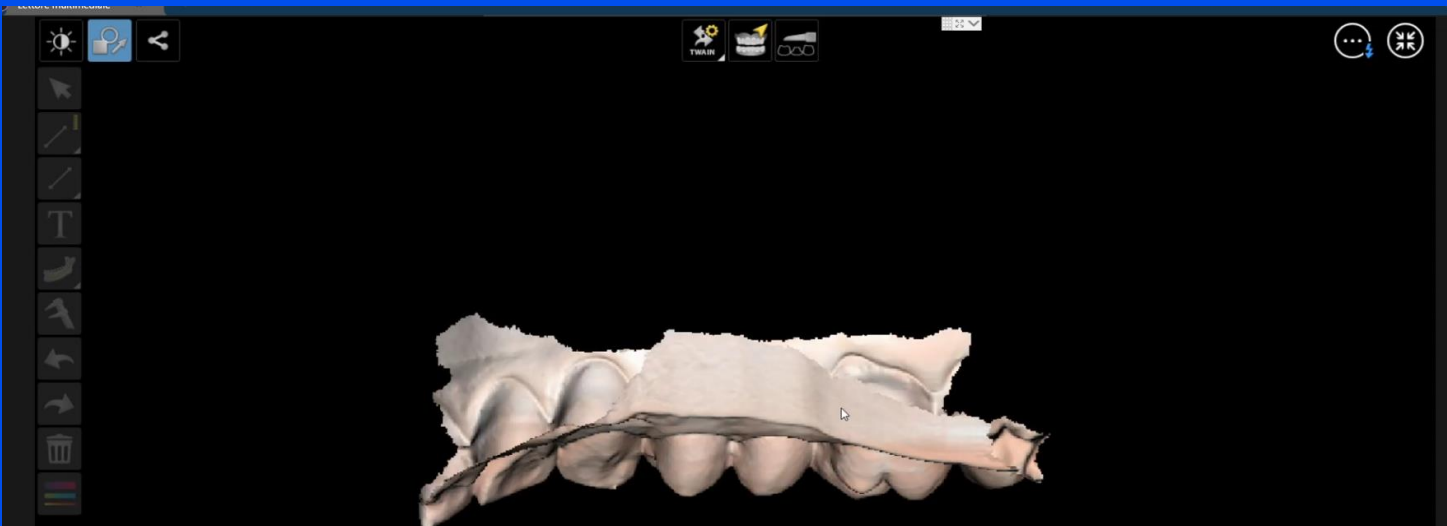

Carestream 3D viewer

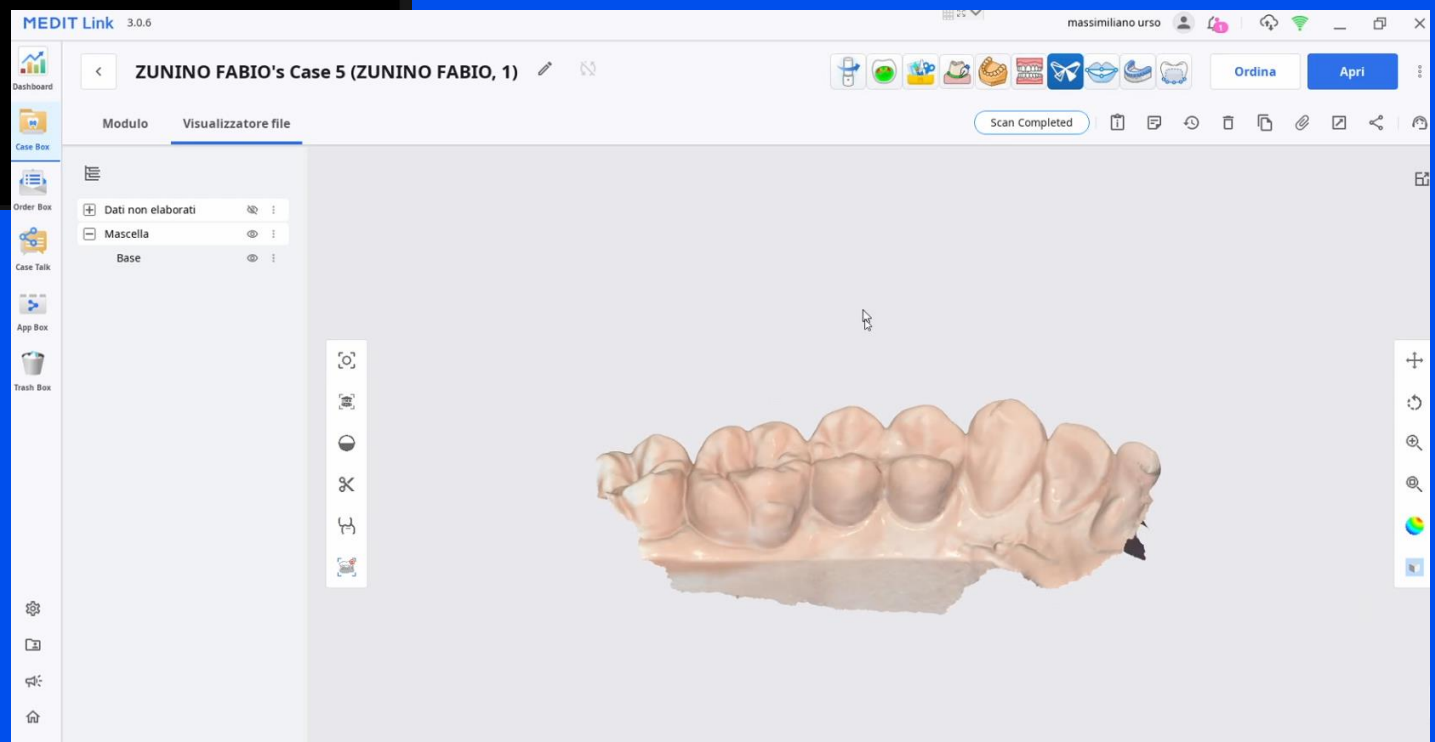

Medit 3D viewer

MEDIT

Thank you!



Scanning Reimagined